

Upcoming road layout changes at Pūhoi

Like many of you, my team and I welcomed Auckland's shift to Alert Level 3 this month.

While the level 4 lockdown was important in keeping us all safe, it did mean we had to pause all non-essential construction work. Only a small number of staff were allowed on site to carry out tasks such as traffic management and ensuring environmental controls were working safely.

Under level 3 some construction work has been able to resume. We are following strict health and safety protocols including restricted access to the construction site, physical distancing requirements, and the use of additional protective clothing.

We are also revisiting our plans for work that was disrupted by the Level 4 lockdown.

This includes the Southern Connection traffic switch, when we will open a small section of the new motorway between the Johnstones Hill Tunnels and Pūhoi.

At this time motorists will start driving over Arawhiti ki Ōkahu (the viaduct over Ōkahu Inlet) and part of the new motorway, merging onto the viaduct after the tunnels and exiting before Pūhoi. Southbound motorists will drive the same route in reverse.

This month I want to share some information about what this important stage of the project means for those travelling near Pūhoi.

As many of you will know, south-facing on- and off-ramps are being built at Pūhoi. As part of the up-coming changes, these ramps will open in stages.

At first, only northbound Hibiscus Coast Highway motorists will travel along the new motorway. They will exit at the new off-ramp and can turn left or right onto Pūhoi Road.

A short time later, northbound and southbound SH1 traffic will begin travelling on this section of the motorway.

The new Pūhoi on-ramp will temporarily open to both northbound and southbound traffic, with motorists travelling north exiting here to re-join SH1.

Pūhoi traffic will be able to use the Pūhoi off-ramp onto Pūhoi Road (as shown in the map below).

Motorists travelling south will use the on-ramp to merge onto the new motorway or can continue along SH1, which will temporarily become southbound only from Pūhoi to the tunnels.

We had planned for this to take place in October however this has changed as a result of the lockdown. We will bring you more information as it comes to hand, or you can visit our website www.nx2group.com/connections.

In the meantime I hope you are all keeping safe and well.

Ngā mihi,

Robert Jones

Project Director

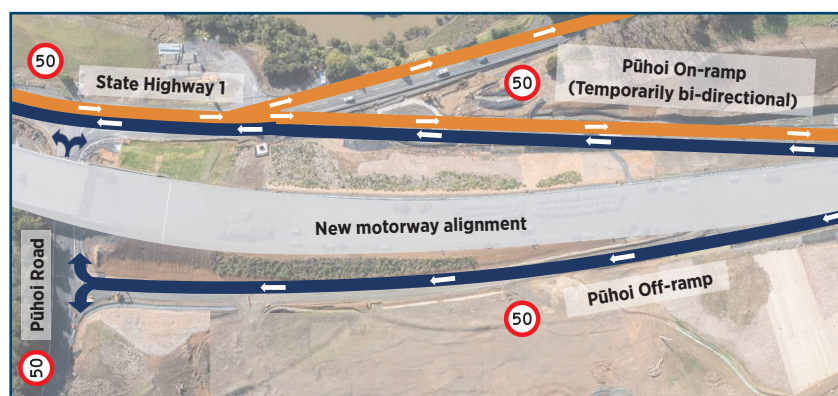

For more information, call the NX2 team on:

24/7 Freephone: 0508 P2WK INFO (0508 7295 4636)

Email: info@nx2group.com

Facebook: Ara Tūhono – Pūhoi to Warkworth

Web: nx2group.com