

CONSTRUCTION UPDATE

KIA ORA EVERYONE!

Last year was a productive year – and this year looks set to be even busier. Let's look at progress as we countdown to delivering a world-class motorway by late 2021.

HIGHLIGHTS TO DATE

- Southern Interchange – we're well into the enabling works at the southern end of the project to connect the Johnstones Hill Tunnels to the new motorway.
- North and south abutments (the area where the bridge connects to the land) for Mahurangi Stream Bridge are now complete.
- Tapuwae o Kahumatamomoe (Moir Hill Bridge) is now open to traffic and the realignment of Wyllie Road is completed.
- Road surfacing starts – sub grade preparation in progress.

HIGHLIGHTS TO COME

- Arawhiti ki Ōkahu (Ōkahu Viaduct) and Arawhiti ki Pūhoi (Pūhoi Viaduct) – we are preparing for beams to be installed using the specialist T-Rex crane.
- Planning is well underway for our next Community Open Day which will be held on May 2.
- Landscaping – this winter we aim to be half-way through planting around one million trees, plants and shrubs – the vast majority are native species.
- We aim to make good progress on the 12 wetlands to be created along the alignment – this will encourage fish and bird life to make them their home.

Pūhoi Road closure for beam installation at Arawhiti ki Pūhoi Bridge

Work is about to begin during the night to install large beams on the Arawhiti ki Pūhoi Bridge across Pūhoi Road. A small section of Pūhoi Road will be closed while this happens, signposted detours will be in place.

For safety reasons, all work will take place at night from 9:00 pm to 04:30 am when traffic volumes are lower. The road will be closed during the below dates and times.

Sun 08 Mar to Thur 12 Mar 2020	Road Closed 9.00pm – 4.30am
---	---------------------------------------

Sun 15 Mar to Thur 19 Mar 2020	Road Closed 9.00pm – 4.30am
---	---------------------------------------

Detours may add a considerable amount of time to journeys, people are encouraged to plan their travel for outside the closure hours where possible. Access will be available for emergency services throughout the closures.

Thank you for your patience while we get this important work done. If you would like to receive a daily email update, please contact info@nx2group.com. More information can also be found at nx2group.com/news or on our Facebook page. We will also ensure our Facebook is kept up to date and closure times will be clearly signposted along State Highway 1.

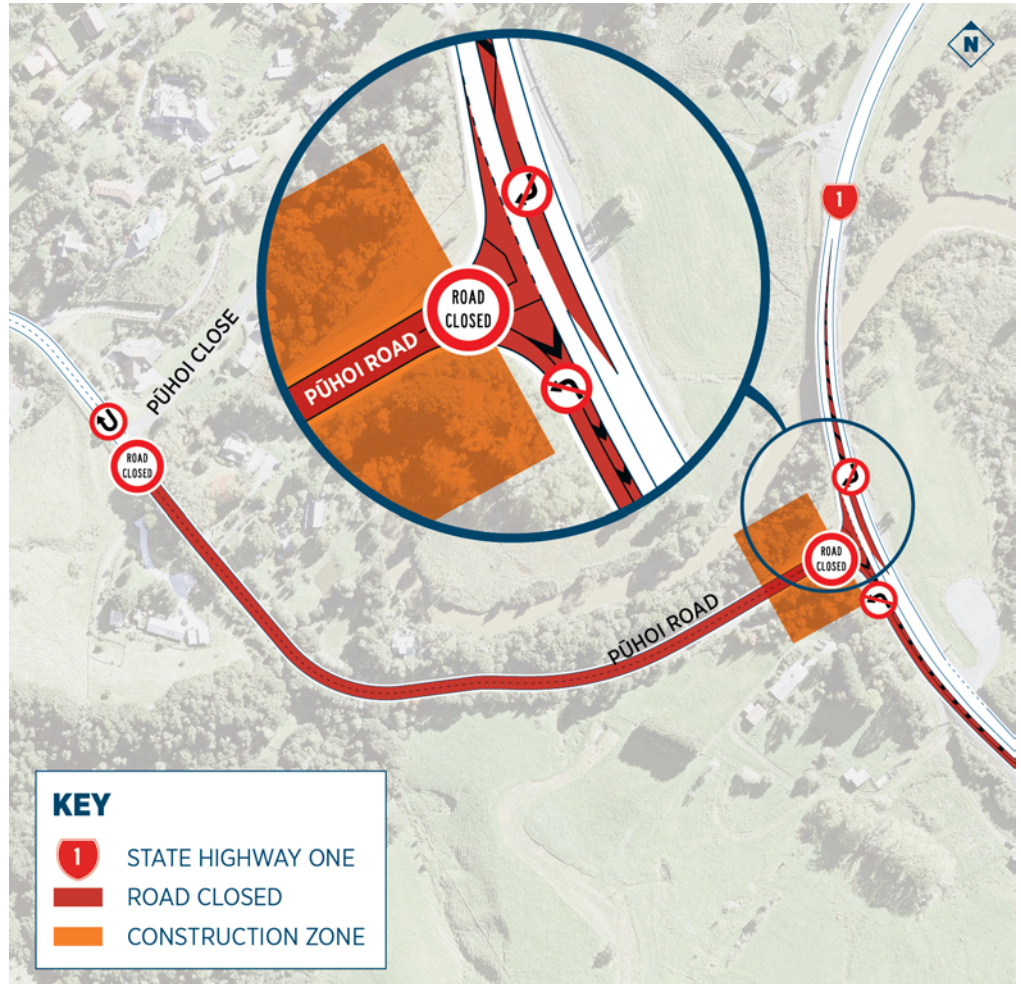



A message from project director Robert Jones

It's great to be back at work feeling rested and revived.

I hope you all had the break you wished for. Refreshed, we will continue to strive to deliver a world-class motorway by late 2021.

You'll see from the project highlights we are making steady progress on both the Arawhiti ki Pūhoi and Arawhiti ki Ōkahu viaducts. We can now see what these impressive structures will look once they are completed.

Installing girders is challenging and complex work. Our focus is always on safety so, to reduce risk to the public, some of this work must be done at night. This is the case for

Arawhiti ki Pūhoi and while we appreciate there will be some disruption for Pūhoi residents with the upcoming Pūhoi Road closure, we are working closely with the community to keep you informed.

Safety is also the reason we have speed reductions in place from 80km to 60km going in and out of Johnstones Hill tunnels. This is because of the works to create the Southern Interchange which connects SH1 to the new motorway.

We do ask for your patience and support while we complete this very important piece of work. Keeping our staff safe while they work alongside SH1 is our highest priority.

Every year we hold a community open day and planning for this year's event is well underway. We can confirm the event will be on Saturday May 2, but I will keep you in suspense as to the nature of the day.

Keep an eye on our Facebook page for updates and tickets towards the end of March. These days are extremely popular and tickets are limited so make sure you get in early to book your ticket to this free event.

Ngā mihi

Robert Jones
Project Director

Project Timeline

2016 » 2017 » 2018 » 2019 » 2020 » 2021

November 2016

Start of enabling works

January 2017

Start of main works

January 2018

Start of structures

November 2019

Start of road surface works

July 2020

Arawhiti ki Pūhoi complete / Arawhiti Pua Ngahere complete

September 2021

Road surface works complete

October 2017

Start of bulk earthworks

September 2020

Arawhiti ki Ōkahu complete

October 2021

Motorway open to traffic

October 2020

All structures complete

November 2020

Earthworks complete

Coming-up this season

- 11-barrel culvert – foundation work completed – pipe laying in next few months
- Piling work for Arawhiti Pua Ngahere (Kauri Eco Viaduct) starts soon in the central northern zone
- Good progress on Pukerito (Northern Roadabout) – drain work starting



Ara Tūhono – Pūhoi to Warkworth project structures

As the project moves closer to completing all structures by October 2020, the progress is clear to see. Have a look at the map below for their location.

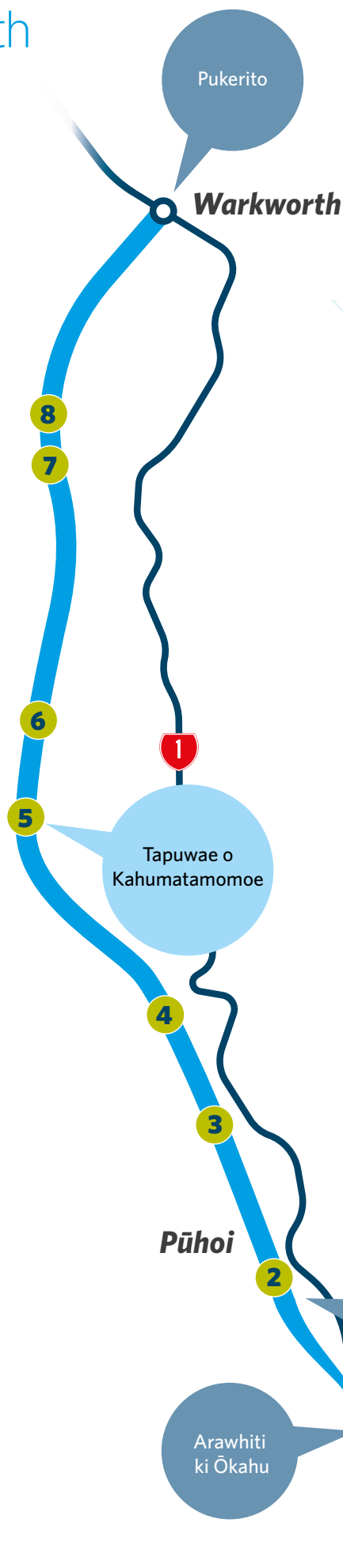

Who's who?

Mark McLaughlin

Your title?

Section Manager – Northern Connection

What's your role with the project?

I coordinate construction activities and manage the interface between the engineering team and the support teams for Pukerito (Northern Connection) on P2Wk. I'm responsible for the overall works programme, temporary and permanent works planning, subcontractor procurement and the execution and quality of the works for my section.

What do you love about it?

Pukerito is a technically and operationally challenging section of the project with many interfaces to manage (live traffic on SH1 and a range of stakeholders). I get a lot of satisfaction from resolving challenges on a daily basis to keep this section of the works on track and from minimising disruption to stakeholders. Every day is different, and I enjoy the balance between office work and getting out on site that my role offers.



What do you do when you're not at work?

Aside from our three young children's busy extra-curricular activity schedule to manage, my wife and I spend as much time as possible with our family at the playground or out on the Hauraki Gulf cruising on our classic wooden launch. I'm also trying to manage getting a new family home built by the end of the year!

Tell us something about yourself that might surprise your workmates?

I'm one of the longest serving staff members on P2Wk. I started on the project in August 2016 so I'm certainly one of the "old boys"! Prior to my current role I have also worked project wide in the project start-up, commercial and key relationships teams.

Opportunity Knocks

Ara Tūhono passes through the rohe of Hōkai Nuku members – Ngāti Manuhiri, Ngāti Rango, Ngāti Whātua, Ngāti Mauku and Ngāti Kauae of Te Uri o Hau. If you whakapapa to these hapū and would like to be involved in learning and working on this project, Hōkai Nuku is working in partnership with NX2 to offer apprenticeships. Check out opportunities at hokainuku.co.nz

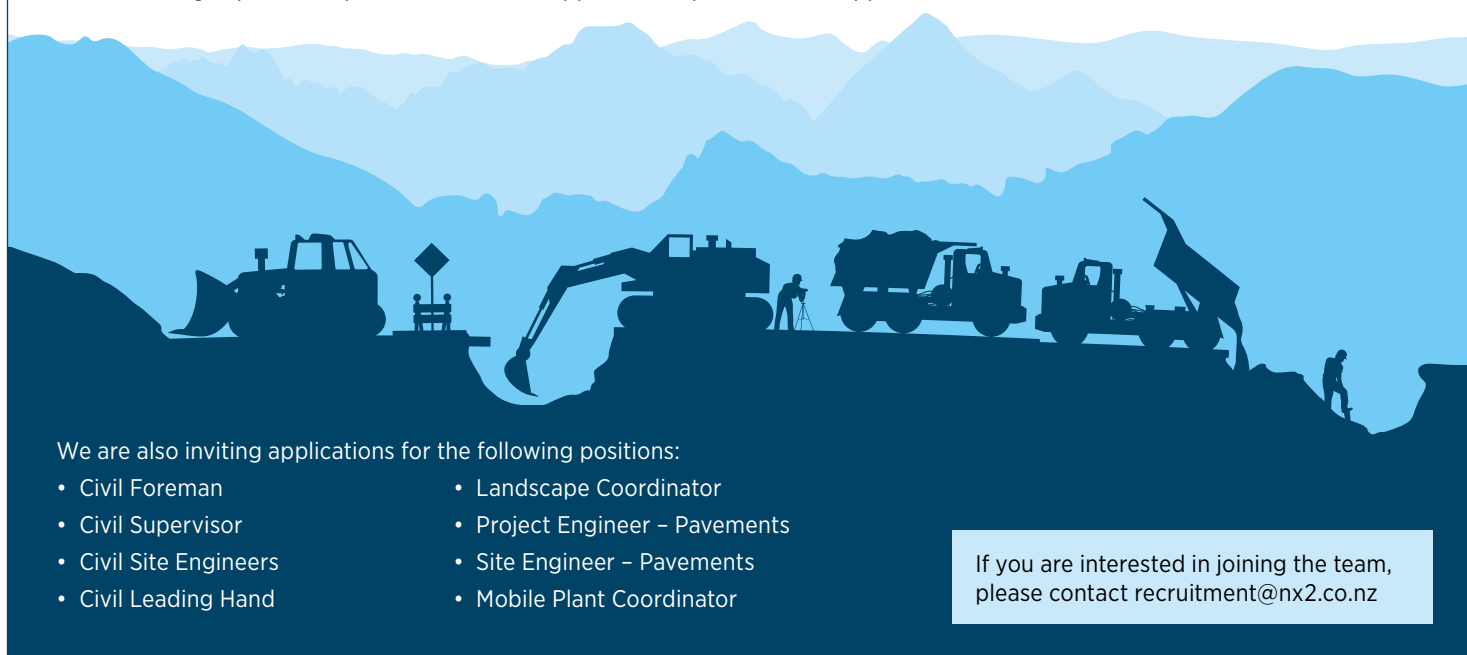

We are also inviting applications for the following positions:

- Civil Foreman
- Civil Supervisor
- Civil Site Engineers
- Civil Leading Hand
- Landscape Coordinator
- Project Engineer – Pavements
- Site Engineer – Pavements
- Mobile Plant Coordinator

If you are interested in joining the team, please contact recruitment@nx2.co.nz

If you do not wish to receive any further newsletters, please [unsubscribe here](#)

A copy of our privacy policy and how we look after the information you provide us is available on our website: www.nx2group.com

E. info@nx2group.com P. 0508 P2WK INFO [f](#) Ara-Tūhono-Pūhoi-to-Warkworth